

# Bridge Light

SL-BR Series

Optional



GPS Sync



GSM Monitoring

*This equipment complies with requirements of the U.S. Coast Guard in 33 CFR part 118*



The SL-BR Series are an LED Bridge Light specifically designed to clearly mark bridges and structures extending over navigable waterways and is used extensively throughout the USA. The SL-BR Series has been designed to offer superior visibility with up to 4NM visible range, and operates in conjunction with existing power supplies.

The light is available as a 180° sectored red model or 360° green model and comes fixed-on as standard. The fixtures are also available with a range of factory-set flash characteristics and sectoring requirements to suit local regulations.

The light is available in two configurations, nominal 12VDC or universal AC (110-240VAC).

The SL-BR series can also be supplied as a complete solar/battery system to comply with requirements of regional governing bodies such as the U.S. Coast Guard, or the IALA Recommendations for the marking of fixed bridges over navigable waters.

**Sealite has a range of other short, medium and long range marine lanterns that may also be used to comply with bridge lighting requirements.**



SL-155 180° model for bridge fenders & abutments

SL-155 Series bridge lights



Sectored Bridge Light



Optional solar/battery systems and optional mounting accessories are available

## Advantage

- Up to 4NM visible range
- Able to operate in conjunction with existing power supplies

## Optional Add Ons

- Solar/battery systems available
- Universal AC: will accept between 110-240VAC
- Mounting accessories

## Technical Specifications \*\*

	SL-BR Series (2NM)	SL-BR4 Series (4NM)
<b>Light Characteristics</b>		
Light Source	LED	LED
Available Colours	Red, Green, other colours available on request	Red, Green, other colours available on request
Visible Range (NM)	AT @ 0.74: 2 (nominal) AT @ 0.85: 2.3	AT @ 0.74: 4 (nominal) AT @ 0.85: 4.6
Horizontal Output (degrees)	360 or 180	360 or 180
Vertical Divergence (degrees)	9	9
Available Flash Characteristics	Steady-on (standard). Other factory set flash patterns available on request	Steady-on (standard). Other factory set flash patterns available on request
LED Life Expectancy (hours)	>100,000	>100,000
<b>Electrical Characteristics</b>		
Current Draw (mA)	VDC Model: 40 @ 12 VDC	VDC Model: 80 @ 12 VDC
Circuit Protection	Integrated	Integrated
Nominal Voltage (V)	VDC Model: 12–48 VDC VAC Model: 110–240 VAC	VDC Model: 12–48 VDC VAC Model: 110–240 VAC
Temperature Range	-40 to 80°C	-40 to 80°C
<b>Physical Characteristics</b>		
Body Material	LEXAN® Polycarbonate – UV-stabilised	LEXAN® Polycarbonate – UV-stabilised
Lens Material	LEXAN® Polycarbonate – UV-stabilised	LEXAN® Polycarbonate – UV-stabilised
Lens Diameter (mm/inches)	107 / 4¼	107 / 4¼
Lens Design	LED optic	LED optic
Mounting	50mm OD pole	50mm OD pole
Height (mm/inches)	105 / 4	105 / 4
Width (mm/inches)	109 / 4¼	109 / 4¼
Mass (kg/lbs)	1.2 / 2½	1.2 / 2½
Product Life Expectancy	Up to 12 years ^	Up to 12 years ^
<b>Certifications</b>		
CE	EN61000-6-3:2007. EN61000-6-1:2007	EN61000-6-3:2007. EN61000-6-1:2007
IALA	Signal colours compliant to IALA E-200-1	Signal colours compliant to IALA E-200-1
USCG	33 CFR Part 118	33 CFR Part 118
Quality Assurance	ISO 9001:2015	ISO 9001:2015
Waterproof	IP67	IP67
<b>Intellectual Property</b>		
Patents	US Pat. No. 6,667,582. AU Pat. No. 778,918	US Pat. No. 6,667,582. AU Pat. No. 778,918
Trademarks	SEALITE® is a registered trademark of Sealite Pty Ltd	SEALITE® is a registered trademark of Sealite Pty Ltd
Warranty *	3 years	3 years
Options Available	<ul style="list-style-type: none"> <li>• Mounting assemblies</li> <li>• Solar/battery systems</li> <li>• Light sectoring</li> <li>• Additional cable</li> <li>• GPS Synchronisation (DC Model)</li> <li>• GSM Monitoring and Control System (DC Model)</li> </ul>	<ul style="list-style-type: none"> <li>• Mounting assemblies</li> <li>• Solar/battery systems</li> <li>• Light sectoring</li> <li>• Additional cable</li> <li>• GPS Synchronisation (DC Model)</li> <li>• GSM Monitoring and Control System (DC Model)</li> </ul>

## Technical Illustration

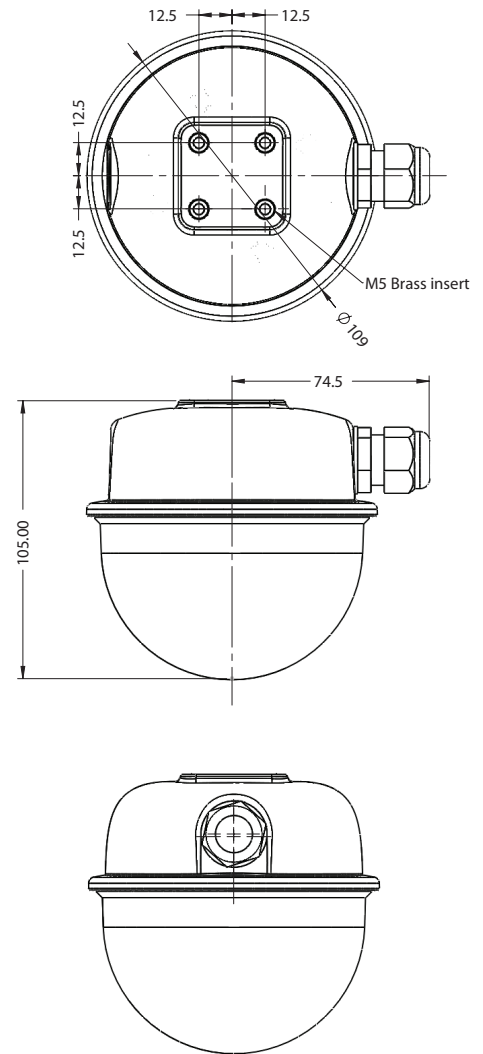

## Power Current in Electrical Circuit (VA)

Bridge Light Colour	VA
White	6.2
Green	6.9
Red	7.8

We believe technology improves navigation™



Sealite Pty Ltd  
Australia  
☎ +61 (0)3 5977 6128

Sealite Asia Pte Ltd  
Singapore  
☎ +65 6829 2243

Sealite United Kingdom Ltd  
UK  
☎ +44 (0) 1502 588026

Sealite USA LLC  
USA  
☎ +1 (603) 737 1311

