

Quick Start Guide

SL-75, 3-5NM+ Solar Marine Lantern with Bluetooth® Controller



A complete user guide is available to download from the Sealite website.
Visit: sealite.com

Introduction

The SL-75 is a solar marine lantern with up to 5NM visible range. The lantern incorporates dual high-performance solar panels for maximum sunlight capture and utilises the latest Bluetooth® technology for convenient configuration and maintenance. The model is supported by the SealitePro® mobile application, designed to allow for complete programming (via Bluetooth®) of the SL-75 lantern.

Installation Parts

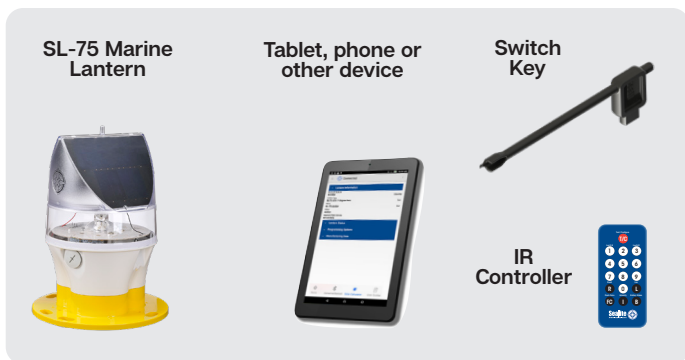

Other Required Tools/Supplies

- SealitePro® App via App Store/Google Play
- Cell phone or Internet Connection

1 Setting up the SL-75 marine lantern

1. Remove the SL-75 Lantern, the Switch Key and IR Controller from their packaging.
2. Use the switch key to remove the SL-75 bung to access the ON/OFF toggle switch. Refer to Diagram 1.
3. Use the switch key to switch ON the SL-75.
4. Place the SL-75 bung back on the base.

2 Pre-installation check

1. The factory default setting of the SL-75 is 0.5 seconds ON and 4.5 seconds OFF with operating mode of Dusk till Dawn. The lanterns flash character can be changed by using the switch key to adjust the rotary switches on the lantern base. Alternatively, adjustments can be made using the IR programmer or downloading the SealitePro® mobile application and connecting to the lantern via Bluetooth®. [Download the user manual for alternate settings.](#)
2. To activate the lantern for testing, ensure the lantern is in darkness for 30 seconds. The SL-75 should begin flashing. In the event the lantern does not begin to flash, ensure the unit is in adequate darkness and check the battery connection.
3. Once the lantern has started to flash, expose the lantern to light and within 30 seconds the SL-75 should stop flashing.

3 Connecting the SL-75 to the SealitePro® App

1. Ensure the lantern is operational, as per instructions provided above. Note that only one device may be connected at any one time.
2. Download the SealitePro® App to your device that is available for both Android® and iOS platforms. Once downloaded, open the App on your device.
3. Connect to the lantern, by pressing “Connect via Bluetooth®”.
4. Select a lantern displayed on the “Scan for Lanterns” screen.
5. Expand the “Lantern Information” drop down menu then press Identify. The lantern will flash quickly several times as confirmation.

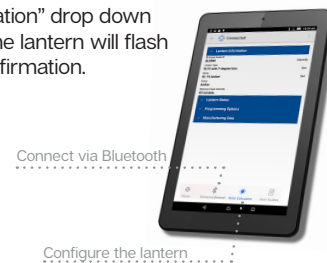

4 Charging the Battery

For optimal performance, new lanterns should be left in full sun for 1-2 days for the battery to charge, prior to installation.

5 Preferred Installation Location

For best lantern performance, ensure solar modules are not covered or in shade. Lanterns exposed in clear view of the sky will result in optimum charging results.

6 GSM Enabled Devices Only

To activate GSM Monitoring services please login to your Star2M account or visit star2m.com to register.

Diagram 1 - Lantern Base

